

# Directions from the train station to the Chair of Prof. Spoerer

Leave the train station and face the Regensburg Arcaden (shopping mall).

Leave the glass-transition by turning left right before entering the shopping mall. You will find yourself at the bus stop "Galgenbergbrücke".

At the bus stop, take bus line 6 or C6 (it will read "Klinikum" or "Universität" on its top). Drive until you reach "Otto-Hahn-Straße".

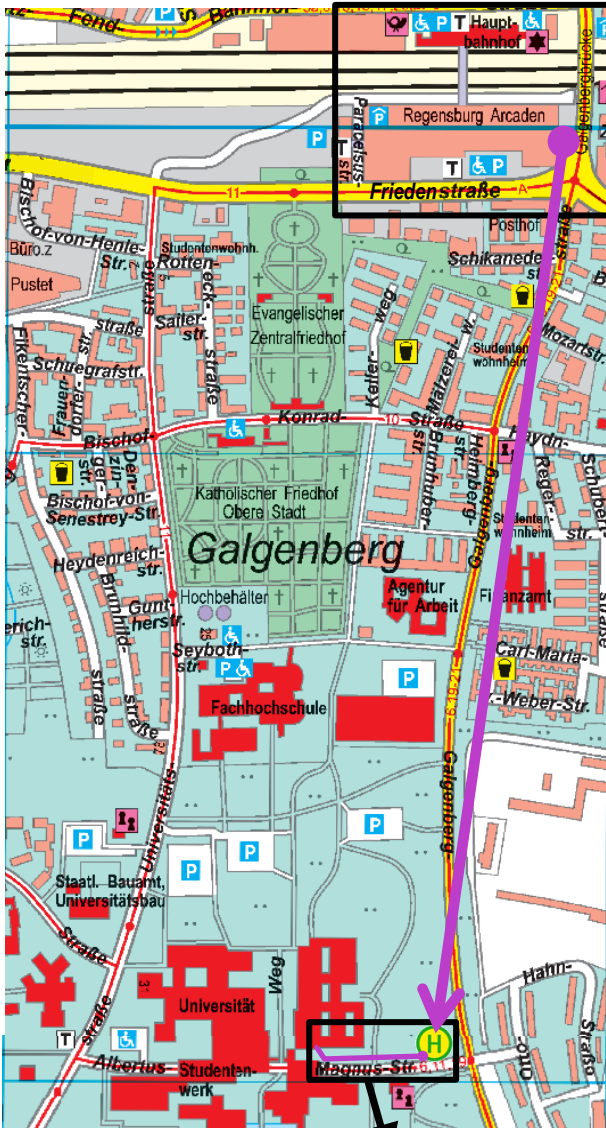

**Professor Mark Spoerer**  
 Chair for Economic and Social History  
 office: PT 3.0.09  
 phone: +49 941 943-5750  
 fax: +49 941 943-81-5750  
 e-mail: Mark.Spoerer@ur.de  
 Secretary: +49 941 943-5751  
 fax: +49 941 943-81-5751  
 e-mail: Sekretariat.WiSo@ur.de  
 Universitätsstraße 31, D-93053 Regensburg  
 internet: <https://go.ur.de/esh>

At the bus station, turn left and walk for about 80 meters along the "Albertus-Magnus-Straße". Enter the second door to your right (right before the tunnel).

You will find yourself in the building "Philosophie/Theologie". Now take the first corridor to your right. The office will be behind the fourth door on your right hand side (PT 3.0.9).

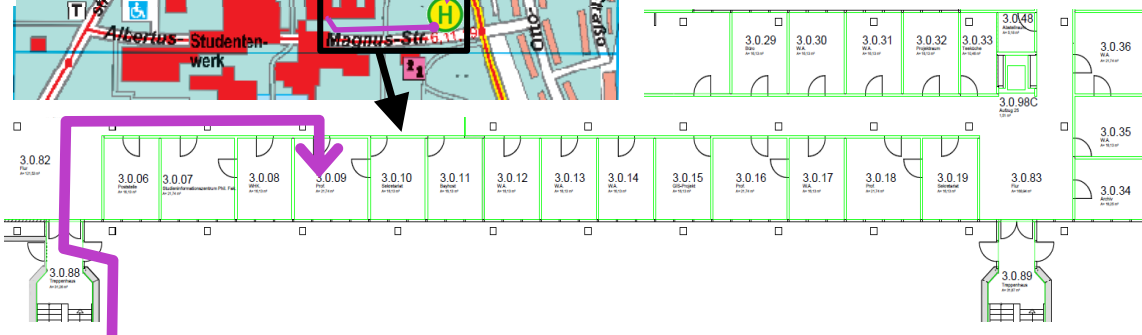

Tunnel

Albertus-Magnus-Straße

